

inscape design college

2012 course registration form

# Autodesk Revit Building

Name  Mr  Ms \_\_\_\_\_

Company (if applicable) \_\_\_\_\_

Company reg. no. \_\_\_\_\_

VAT Number \_\_\_\_\_

Postal Address \_\_\_\_\_

\_\_\_\_\_ Code \_\_\_\_\_

Tel/Cell ( \_\_\_\_\_ ) \_\_\_\_\_

Fax ( \_\_\_\_\_ ) \_\_\_\_\_

Email \_\_\_\_\_ @ \_\_\_\_\_

I am currently enrolled at Inscape for:

Architectural Draughting  Interior Decorating

My course fees are paid up to date

I heard about Inscape and it's courses from:

\_\_\_\_\_

Please enrol me in  Durban

Please enrol me for the course ticked  below:

Autodesk Revit Building - Course Schedule  
**R 5 150.00**

One Week. Monday to Friday 8:45 am - 12:45 pm

Mar 26 – 29

- INSCAPE is highly respected throughout the design industry and the Inscape Certificate is an assurance of a high level of proficiency.
- Each student has full and exclusive use of a computer throughout the course
- INSCAPE campuses are conveniently situated in:
  - Johannesburg - 1 Cecil Avenue, Melrose Estate
  - Pretoria - 431 Atterbury Road, Menlo Park
  - Cape Town - A302 The Armoury, Buchanon Sq,  
160 Sir Lowry Road, Woodstock
  - Durban - 106 Montpelier Rd, Morningside
- These courses are run subject to demand

I understand and accept that:

1. the course fees must have been paid to Inscape Design College a minimum of two weeks before the course commencement date;
2. this enrolment cannot be cancelled without written notice a minimum of fourteen days prior to the course commencement date, whether or not the fees have been paid;
3. the courses are offered subject to demand; and
4. certificates will only be awarded to students who have successfully completed the course and whose fees have been paid in full.
5. i must have a fair knowledge of and experience in the use of a personal computer and Windows as the program is taught on the PC.

I include herewith proof of payment of the full fee of R 5 150.00

Special dietary requirements: \_\_\_\_\_

Signature \_\_\_\_\_

Date \_\_\_\_\_

ID number

Internet Transfer  Direct Deposit

Mastercard  Visa Expiry: \_\_\_\_\_

Please include last 3 digits on back of credit card AND a photocopy of your ID and BOTH sides of credit card.

Internet Transfer / Direct Deposit: The course fee may be paid directly into our Standard Bank account.

Acc name: Inscape Design College. Acc No: 001 66 44 17

Branch: 007205. Please fax (011 447 7054) or email (accounts@inscape.co.za) the proof of payment to us.



# Autodesk Revit

## 2012 course schedule

Johannesburg  
1 Cecil ave,  
Melrose Est  
tel 011 327 2002  
fax 011 447 7054

Pretoria  
431 Atterbury Rd,  
Menlo Park  
tel 012 346 2189  
fax 012 346 7529

Durban  
106 Montpelier Rd,  
Morningside  
tel 031 303 8016  
fax 031 303 5373





---

# Autodesk Revit

---

## Revit Building Certificate Course

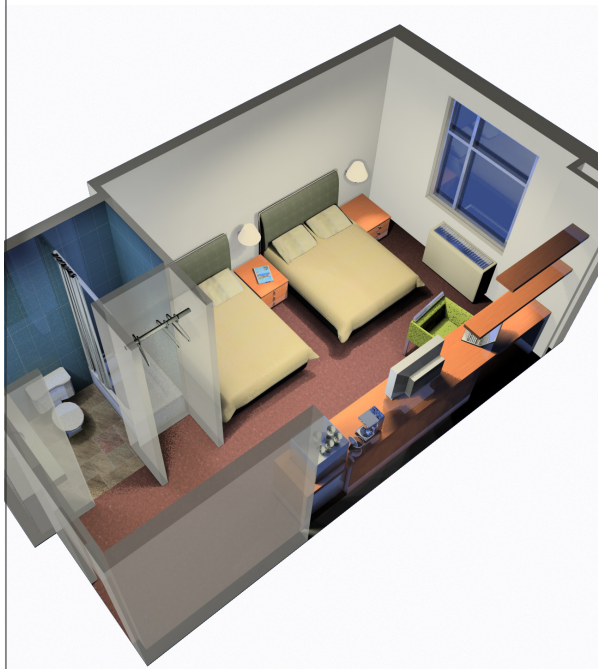

Purpose-built for building information modeling (BIM), Revit Building mirrors the real world of architecture by letting you work on buildings holistically, rather than in terms of separate floor plans, sections, and elevations.

With Autodesk Revit Building, you get back to what you love: designing buildings without your software getting in the way. Work in any view that makes sense, maintain the ability to design throughout different design phases, and quickly and easily make changes to major design elements. Create comprehensive design proposals in record time. See your ideas realized on the fly with 3D views and instant shadows. You can even make late-stage changes without worrying about coordinating your plans, schedules, and construction documents.

---

### WHAT WILL I LEARN?

---

The courses are hands-on, tutor-led, result-oriented and cover the Revit Architecture program to a User level of proficiency.

At the end of the course you should know:

- The Revit Interface
- Modeling
- Material Editing and Application
- Lighting Techniques
- Animation

During the course students will design an interior space with furniture, produce textures for scene and create an animated fly through.

---

### WHAT BACKGROUND SHOULD I HAVE?

---

Students must:

- be windows literate and know how to use a mouse
- have enthusiasm for design and technology

---

### IS THIS A PRACTICAL HANDS-ON COURSE?

---

There are never more than six students on a Course and each has the exclusive use of the computer equipment for the duration of the Course.

---

### ARE THERE TAKE-HOME COURSE NOTES?

---

Comprehensive Course notes are provided, together with information about graphic software.

---

### DO I GET A CERTIFICATE?

---

INSCAPE is highly respected throughout the design industry and the Inscape Certificate is an assurance of a high level of proficiency.